

**RAILKING**<sup>®</sup>  
By M.T.H. Electric Trains

# GS-4

## 4-8-4

30-4039-1

30-4039-0a



Rev. 3-1-01



# GS-4 Steam Engine

## Engine Parts

Name and Number	Part #	\$Price Per Unit	Name and Number	Part #	\$Price Per Unit
1.) Shell ( boiler )( metal ) ( S.P Daylight )( #4449 )( orange, red, silver, black )	FB-1200182	*100.00	38.) Crosshead ( nickel ) ( 38.8mm long )	EC-1250016	5.00
2.) Screw ( 4/40x6.0mm )( roundhead )	IA-0000003	0.15	39.) Insulator washer ( white )	ID-0000033	0.15
3.) Bell ( nickel )	FB-1200002	4.00	40.) Voltage regulator ( LM2937ET )	AG-0000032	3.00
4.) Number board housing ( right )( black )( S.P Daylight )( #4449 )	FB-1210041	10.00	41.) Insulator ( clear ) ( 13.0x19.0x0.1mm thick )( single hole )	ID-0000024	0.15
5.) Number board housing ( left )( black )( S.P Daylight )( #4449 )	FB-1220048	10.00	42.) Wire nut ( yellow )	BI-4500003	0.25
6.) Side panel ( orange ) ( right )( S.P Daylight )( #4449 )	FB-1210038	*15.00	43.) Pin ( 5.0x25.0mm ) ( 1.5x8.0mm flathead )( 2 e-clip grooves )	IG-0000033	0.50
7.) Side panel ( orange ) ( left )( S.P Daylight )( #4449 )	FB-1220045	*15.00	44.) Draw bar	FB-1200181	3.00
8.) Handrail ( nickel ) ( right )( boiler )( 196.0x30.0x25.0mm )	FB-1210037	2.00	45.) Washer ( 5.5x10.0x0.5mm )	ID-0000075	0.15
9.) Handrail ( nickel ) ( left )( boiler )( 196.0x30.0x25.0mm )	FB-1220044	2.00	46.) E-clip ( 3.5x9.0x0.6mm )	IF-0000009	0.15
10.) Stanchions ( black )( metal )	FB-1200024	0.25	47.) Spring ( conical ) ( 6.5x12.5x13.0mm )( 0.6mm thick wire )	IE-0000062	0.50
11.) Marker light housing (black)	FB-1200184	6.00	48.) Washer ( 5.5x15.0x1.0mm )	ID-0000095	0.15
12.) Boiler front ( silver ) ( S.P Daylight )( #4449 )( metal )	FB-1230004	*12.00	49.) Truck ( black ) ( 2 axles )( trailing )( boiler )	DA-1240032	25.00
13.) Lens ( headlight )( clear )	FA-1230022	2.00	50.) Screw ( 6/32x6.0mm )( washer head )	IA-0000214	0.15
14.) Light reflector (black)(plastic)	CI-0000024	3.00	51.) Nut ( 2.5x5.0x10.0mm )	IC-0000005	0.50
15.) Smoke unit ( Proto-Sound 2.0® )	AA-0000029	50.00	52.) Insulator (pick-up)(bottom)	BD-0000001	2.00
16.) Bulb ( clear )( headlight ) ( 6V )( screw base )( small globe )	CA-0000038	1.00	53.) Pick-up ( 8.0x11.0mm roller )( 28.0mm long )	BD-0000048	5.00
17.) Bracket ( black ) ( 3 step )( headlight / smoke unit )	IH-0000085	3.00	54.) Crosshead guide assembly	EA-1200013	6.00
18.) Boards (Proto-Sound 2.0®)	AE-0000001	*200.00	55.) Pin ( 3.0x15.0mm )	IG-0000003	0.50
19.) Screw ( 6/32x10.0mm )( roundhead )	IA-0000040	0.15	56.) Spring ( cylindrical ) ( 6.5x9.0mm )( 0.5mm thick wire )	IE-0000009	0.50
20.) Tach board	AG-0000033	6.00	57.) Bracket (black)(lead truck)	IH-1230006	1.00
21.) Motor ( RS-365SH ) ( 8.0x21.0mm worm gear )( 14.5mm long threads ) ( 9.0x30.0mm flywheel)(tach board mounting bracket)	BE-0000077	25.00	58.) Screw ( 4/40x6.0mm )( washer head )	IA-0000028	0.15
22.) Tach tape ( fits 30.0mm flywheel )( black & white striped tape )	BE-0000069	1.00	59.) Truck ( black ) ( lead )( 2 axle )( boiler )	DA-1230022	20.00
23.) Motor mount ( fits GS-4 )	BI-0000034	15.00	60.) E-clip ( 2.5x6.0x0.5mm )	IF-0000004	0.15
24.) Screw ( yellow Zinc ) ( M2.5x6.0mm )( roundhead w/ lock washer )	IA-0000089	0.15	61.) Spacer ( cup ) ( 3.5x15.0x2.5mm )	ID-0000014	1.00
25.) Bracket ( Aluminum ) ( for Proto-Sound 2.0® boards )	IH-0000170	3.00	62.) Traction tire	DE-0000022	0.75
26.) Switch ( small )	BB-0000009	5.00	NS.) Wire harness ( 10 pin female PC Board )	BC-1200013	15.00
27.) Screw ( 6/32x6.0mm )( roundhead )	IA-0000027	0.15	NS.) Wire harness ( 7 pin male plug )	BC-1200014	8.00
28.) PC board (10 pin)(female)	AG-0000039	8.00	NS.) Wire harness ( 5 pin male plug )	BC-1200015	5.00
29.) Screw ( M2x4.0mm )( roundhead )	IA-0000058	0.15	NS.) Wire harness ( 4 pin male plug )	BC-1200016	4.00
30.) Screw ( 4/40x14.0mm )( roundhead )	IA-0000122	0.15	NS.) Wire harness ( single metal eyelet mounted on 70.0mm long red wire )	BC-1200024	2.00
31.) Screw ( nickel ) ( M3x6.0mm )( roundhead )	IA-0000015	0.15	NS.) Wire harness ( single metal eyelet mounted on 70.0mm long black wire )	BC-1200025	2.00
32.) Insulator ( pick-up )( top )	BD-0000026	2.00	NS.) Wire harness ( two metal eyelets connected together by a 40.0mm red wire )	BC-1200026	2.00
33.) Drive block (black)(4 axle)	DF-1200027	*75.00	NS.) Screw ( 4/40x4.0mm ) ( roundhead ) ( used to seal grease hole in drive shaft cavity )	IA-0000021	0.15
34.) Side rod ( nickel ) ( 1.0x87.5mm )( 4 bolt holes )	EC-1250023	2.00	NS.) Washer ( fiber )( black )	ID-0000040	0.15
35.) Bolt ( nickel ) ( M3x8.0mm )( hex head )( 4.0x2.5mm shoulder )	IA-0000087	1.00			
36.) Drive rod ( nickel )	EC-1250022	5.00			
37.) Screw ( 6/32x8.0mm )( roundhead )	IA-0000050	0.15			

\*Requires Exchange

All parts are priced as each



# Engine Parts

Name and Number                      Part #                      \$Price Per Unit

## Loco-Sound® Parts

2.) Screw ( 4/40x8.0mm ) ( roundhead )( for mounting board to bracket )	IA-0000011	0.15
18.) Boards ( Loco-Sound® )	AE-0000003	*100.00
25.) Bracket ( Aluminum ) ( for Loco-Sound® boards )	IH-0000171	3.00
39.) Insulator washer ( white )	ID-0000033	0.15
41.) Insulator ( clear )	ID-0000024	0.15
NS.) Wire harness ( 10 pin female PC Board )	BC-1200012	15.00
NS. Wire harness ( 5 pin male plug )	BC-1200018	5.00
NS.) Ferrite bead ( grey ) ( 4.6x9.7x9.4mm )( barrel shape )	AI-0000030	2.00
NS.) Capacitor ( blue )( .01 uF ) ( 16.0x2.0mm )( 2 wire leads )	AI-0000031	2.00

\*Requires Exchange  
All parts are priced as each

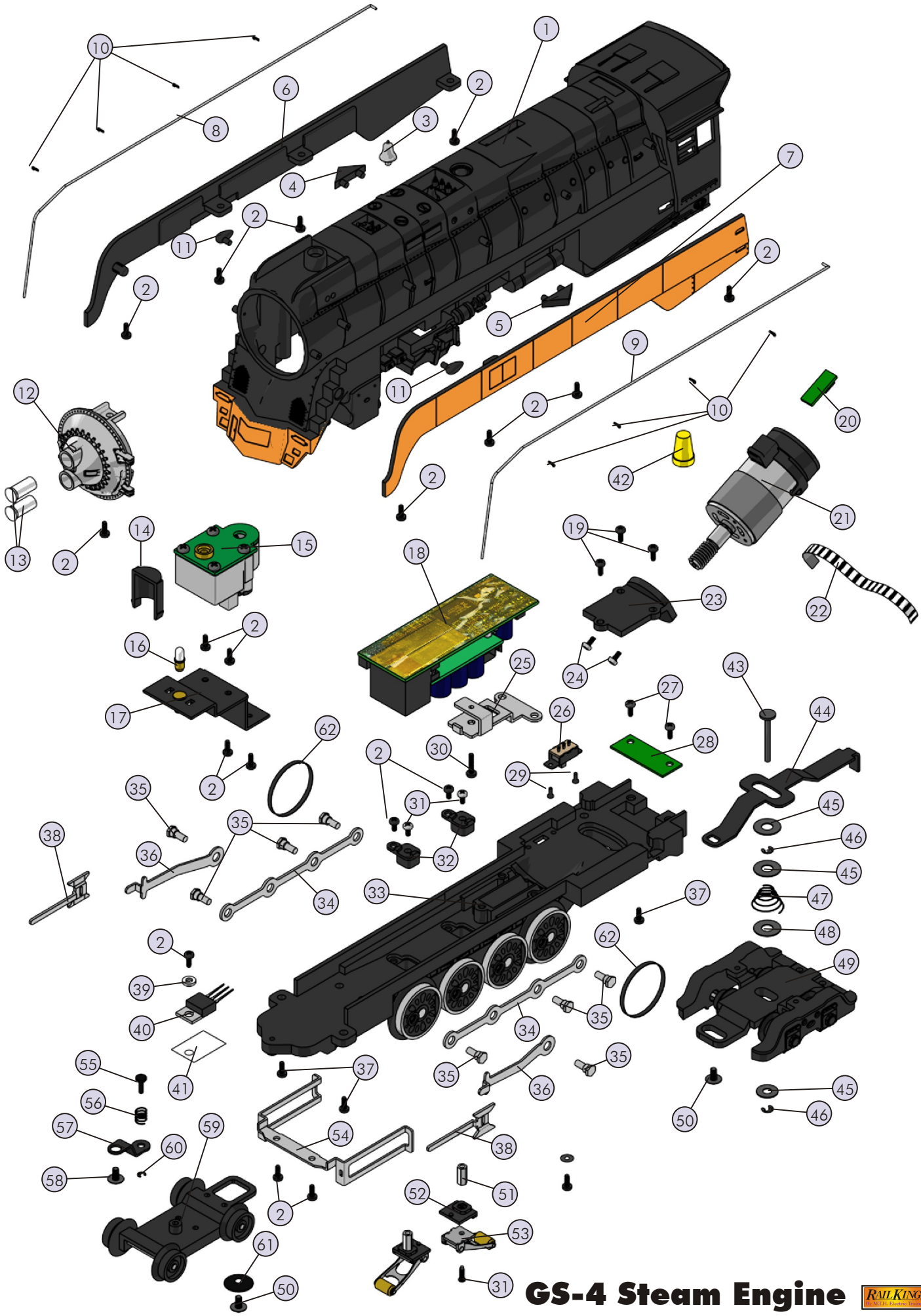

# GS-4 Steam Engine Tender

## Tender Parts

Name and Number	Part #	\$Price Per Unit
1.) Shell ( tender )( plastic ) ( S.P. Daylight )( orange, red, silver, black )	GA-1200071	*40.00
2.) Battery	BG-4000001	9.95
3.) Screw ( M3x6.0mm )( roundhead )	IA-0000016	0.15
4.) Screw ( M3x4.0mm )( roundhead )	IA-0000010	0.15
5.) Bracket ( battery )	IH-0000042	3.00
6.) Speaker cone (black)(plastic) ( 44.0x48.0x23.0mm )( 2 screw hole tabs )	BF-0000016	5.00
7.) Screw ( M3x8.0mm )( roundhead )	IA-0000035	0.15
8.) Volume pot ( small ) ( blue w/ green board )	BI-0000040	5.00
9.) Spacer ( black ) ( 3.0x6.0x4.0mm )( plastic )	ID-0000071	0.15
10.) Speaker ( Cuistack ) ( GF0501 )( 16 ohms )( 0.25 watt )	BF-0000007	8.95
11.) Chassis ( black ) ( tender )( metal )	GB-1200038	*15.00
12.) Wire harness ( 10 pin plug ) ( 275.0mm long wires )	BC-1200010	12.00
13.) Screw ( 4/40x6.0mm )( washer head )	IA-0000028	0.15
14.) Draw bar ( 60.7x10.0x1.2mm ) ( 2 large holes, 1 small hole )( 1 step, 2 bends )	GA-1200027	3.00
15.) Screw ( M3x15.0mm )( washer head )( self-drilling )	IA-0000262	0.15
16.) Screw ( 6/32x6.0mm )( washer head )	IA-0000212	0.15
17.) T-Bar	IG-0000001	0.50
18.) Coupler (Proto Sound 2.0®) ( 51.0mm long )	DD-0000032	10.00
19.) Spring ( 6.5x14.0mm )( 0.5mm thick wire )	IE-0000022	0.50
20.) Washer ( 4.5x10.0x6.0mm )	ID-0000009	0.15
21.) E-clip ( 3.0x8.0x0.5mm )	IF-0000001	0.15
22.) Truck ( black ) ( 3 axle )( leading/trailing )( tender )	DA-1250005	25.00
23.) Gasket ( black ) ( 43.8x49.8x3.0mm )( foam )	IB-0000009	0.50
NS.) Axle bearing ( black ) ( 3 axle )( plastic )	DC-0000005	3.00
NS.) Wire harness ( 2 pin white male plug )( wires connect to speaker )	BC-1200022	2.00
NS.) Wire harness ( 2 pin black male plug )	BC-1200023	2.00

## Loco-Sound® Parts

10.) Speaker ( Cuistack ) ( GF0501 )( 8 ohms )( 0.25 watt )	BF-0000015	8.95
11.) Chassis ( black ) ( tender )( metal )	GB-1200037	*15.00
12.) Wire harness ( 10 pin plug )( 275.0mm long wires )	BC-1200011	12.00
19.) Spring ( 6.5x11.0mm )( 0.5mm thick wire )	IE-0000063	0.50
20.) Washer ( black )( plastic ) ( 4.6x8.5x0.5mm )( cup shaped for spring )	ID-0000060	0.15
NS.) Coupler ( mechanical )( 51.0mm long )	DD-0000011	3.00

## Tender Parts

Name and Number	Part #	\$Price Per Unit
NS.) Armature ( 45.0mm long )	DD-4000007	1.00
NS.) Weight ( Aluminum block ) ( 40.0x34.5x20.0mm )( 158 grams )	II-0000013	4.00
NS.) Wire harness ( 2 pin white plastic male plug ) ( wires connect to speaker )	BC-1200022	2.00

\*Requires Exchange  
All parts are priced as each

# GS-4 Steam Engine Tender

