



# NW-2

"Calf" Unit

30-2156-3

30-2157-3



# NW-2 "Calf" Unit

## Parts

NameandNumber	Part#	\$PricePerUnit	NameandNumber	Part#	\$PricePerUnit
1.) Shell(AT&SF)(#2419)	FC-2200136	*55.00	32.) Screw	IA-0000016	0.15
1.) Shell(Southern)(#1039)	FC-2200137	*55.00	(M3X6.0mm)(roundhead)		
2.) Handrail(black)(right)	FC-2210006	5.00	33.) Truckside(black)	DB-2060002	7.00
3.) Handrail(black)(left)	FC-2220006	5.00	34.) Screw	IA-0000031	0.15
4.) Handrail(black)	FC-2250002	3.00	(M3X12.0mm)(washerhead)(self-drilling)		
(left andrightsides)			35.) Pilot(blackw/silverstripes)	DG-2230010	15.00
5.) Headlightlens	FA-2230012	2.00	35.) Pilot(blackw/whitestripes)	DG-2230011	15.00
6.) Bulb	CG-0000002	0.95			
(18V)(smallglobe)(bayonetbase)					
7.) Socket	CH-0000005	0.15			
8.) Screw	IA-0000022	0.15			
(M2.5X3.0mm)(roundhead)					
9.) Handrail(black)	FC-2250003	5.00			
10.) Spring	IE-0000025	0.50			
(8.0X15.0mm)(w/0.6mmthickwire)					
11.) Bolt	IA-0000088	1.00			
(8/32X15.0mmw/6.0x8.0mmshoulder)(slottedhead)					
12.) Chassis	DH-2200011	*15.00			
13.) Screw	IA-0000003	0.15			
(4/40X6.0mm)(roundhead)					
14.) Pilot(blackw/silverstripes)	DG-2240006	15.00			
14.) Pilot(blackw/whitestripes)	DG-2240007	15.00			
15.) Fueltank(black)	FC-2200138	*10.00			
16.) T-bar	IG-0000001	0.50			
17.) Spacer	ID-0000047	0.50			
(4.5X13.0X3.0mm)(metal)					
18.) Coupler	DD-0000003	3.00			
19.) Couplerarmature	DD-0000007	1.00			
20.) Spring	IE-0000019	0.50			
(6.5X16.0mm)(w/4.0mmthickwire)					
21.) Washer	ID-0000041	0.15			
(4.5X10.0X0.6mm)					
22.) E-clip	IF-0000002	0.15			
(3.0X8.0X0.5mm)					
23.) Screw	IA-0000016	0.15			
(M3X6.0mm)(roundhead)					
24.) Screw	IA-0000003	0.15			
(4/40X6.0mm)(roundhead)					
25.) Screw	IA-0000010	0.15			
(M3X4.0mm)(roundhead)					
26.) Insulator(pick-up)(top)	BD-0000035	1.00			
27.) Truckblock	DA-2050007	*20.00			
(2axle)(non-powered)					
28.) Screw	IA-0000003	0.15			
(4/40X6.0mm)(roundhead)					
29.) Nut	IC-0000004	0.50			
(2.5X5.0X6.0mm)					
30.) Insulator	BD-0000039	2.00			
(pick-up)(bottom)(rectangle)					
31.) Pick-up	BD-0000025	5.00			

\*RequiresExchange

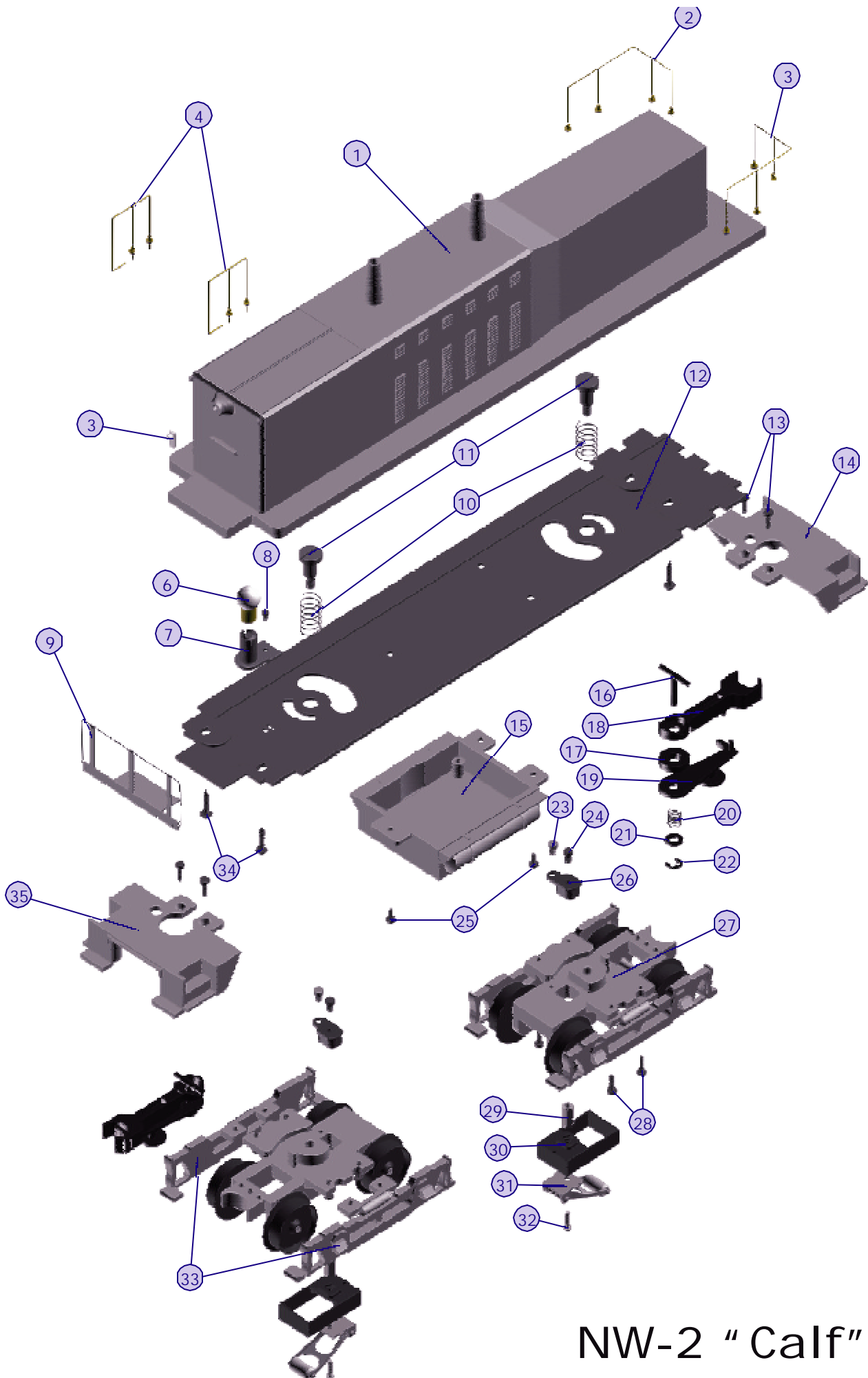

NW-2 "Calf" Unit